

SERIES ELT & BLT

LIQUID LINE PRESSURE TO OPEN AND AIR PRESSURE TO CLOSE

FEATURES

- Fail-Dry® design
- Teflon shaft for non-sticking
- Clear Acrylic cylinder for visual indication of valve position
- Poppet seat and U-cup seals for low friction operation
- Million cycle design with bubble tight shutoff

SPECIFICATIONS*

	SERIES ELT	SERIES BLT
BODY	PVC	PVC
SHAFT	20% GLASS FILLED TEFLON	
CYLINDER	ACRYLIC	
SEALS	BUNA-N, VITON, & EPDM	
SERVICE	PRESSURE	
FASTENERS	STAINLESS STEEL	
ENDS	THREADED NPT or BSP	
AIR INLET	1/8 NPT or BSP	
OPTIONS:		
ENDS	SOCKET or FLANGED	
AIR SOLENOID	3-WAY	

Note: Air inlet connections are 1/8 NPT

*For Special Materials or Variation Consult the Factory

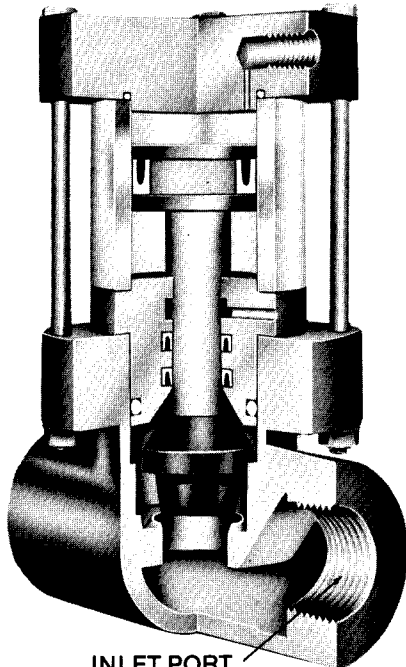

INLET PORT
SERIES ELT
3/4 - 2

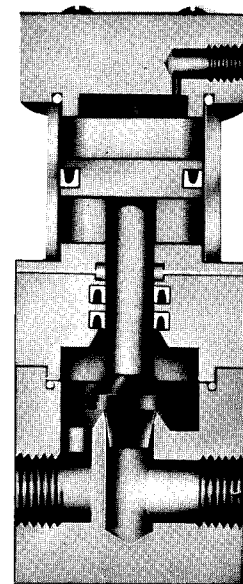

SERIES BLT
1/2 ONLY

SERIES ELT DIMENSIONS

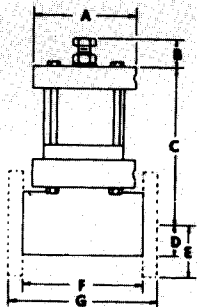

	3/4		1		1 1/4		1 1/2		2	
	in.	mm	in.	mm	in.	mm	in.	mm	in.	mm
A	3 1/2	88.9	3 3/4	95.3	4 9/16	115.9	5	95.3	6	152.4
B	1 3/4	44.5	1 3/4	44.5	1 5/8	41.3	1 3/4	44.5	2 3/8	60.3
C	4 1/4	108.0	4 5/8	117.5	5 1/4	133.4	5 1/4	133.4	6 7/8	174.6
D	1	25.4	1 1/8	28.6	1 3/8	34.9	1 3/8	34.9	1 11/16	42.9
E	1 15/16	49.2	2 1/8	54.0	2 5/16	58.7	2 1/2	63.5	3	76.2
F	3 11/16	93.7	4 1/2	114.3	5 1/2	139.7	5 1/2	139.7	7 1/8	181.0
G	4 11/16	119.1	5 5/8	142.9	6 3/4	171.5	6 7/8	174.6	8 5/8	219.1

SERIES BLT DIMENSIONS

	1/2	
	in.	mm
A	2 3/8	60.3
B	5 3/8	136.5
C	7/8	19.9
D	2 3/8	60.3

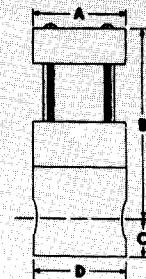

PRESSURE RATINGS

LIQUID

Maximum: 125 PSI (8.63 BARS)
Minimum: 15 PSI (1.0 BAR)
These valves are not recommended with liquid inlet pressures less than 15 PSI (1.0 BAR)

AIR

Maximum: 100 PSI (6.90 BARS)

RECOMMENDED MINIMUM AIR PRESSURE REQUIRED TO CLOSE VALVE AGAINST LIQUID LINE PRESSURE

LIQUID LINE PRESSURES	psi		25		50		100		125	
	bars	psi	bars	psi	bars	psi	bars	psi	bars	
1/2	30	2.06	30	2.06	30	2.06	30	2.06	30	2.06
3/4	15	1.04	20	1.38	30	2.07	40	2.76	40	2.76
1	15	1.04	20	1.38	40	2.76	45	3.11	45	3.11
1 1/4	15	1.04	25	1.73	40	2.76	45	3.11	45	3.11
1 1/2	20	1.38	35	2.42	55	3.80	60	4.14	60	4.14
2	20	1.38	30	2.07	45	3.11	55	3.80	55	3.80

CAUTION: Use air flow rate valves to slow down valve closing speed in applications where water hammer is present. Especially important in larger pipe sizes with high flow rates.

SERIES ELT PART NUMBERS

PIPE SIZE	Cv FACTOR	FULL OPEN TO FULL CLOSE		MANUALLY SET THROTTLING LIMIT STOP	
		BUNA SEALS	VITON SEALS	BUNA SEALS	VITON SEALS
3/4	8.5	ELT075B	ELT075V	ELT075B-LS	ELT075V-LS
1	15.0	ELT100B	ELT100V	ELT100B-LS	ELT100V-LS
1 1/4	24.0	ELT125B	ELT125V	ELT125B-LS	ELT125V-LS
1 1/2	33.0	ELT150B	ELT150V	ELT150B-LS	ELT150V-LS
2	60.0	ELT200B	ELT200V	ELT200B-LS	ELT200V-LS

SERIES BLT PART NUMBERS

PIPE SIZE	Cv FACTOR	FULL OPEN TO FULL CLOSE		MANUALLY SET THROTTLING LIMIT STOP	
		BUNA SEALS	VITON SEALS	BUNA SEALS	VITON SEALS
1/2	3.6	BLT050B	BLT050V	BLT050B-LS	BLT050V-LS

NOTE: For EPDM seals remove the "B" or "V" and substitute "EP" in the part number.

DIMENSION & PART NUMBER UPDATE – SERIES EAT, ELT, EST 2-Way Valves Design Revision • Machined Solid Bodies

DESIGN:

Series EAT, ELT and EST 2-Way Shut-off Valves with visual position indicator have been re-designed. The main valve body is now machined from solid thermoplastic stock; the previous design was fabricated.

SPECIFICATIONS:

The pressure ratings, pressure requirements, material specifications and features in Catalog ASO-3 still apply and should be referred to.

PART NUMBERS:

To avoid confusion with parts and seal kits for fabricated valves, the part numbers for the new designs have been changed. For all future EAT, ELT, EST-NC and EST-NO orders, replace the "E" in the part number with a "B". For example, EST100V-NC-PV should be ordered as BST100V-NC-PV.

DIMENSIONS:

Some of the body dimensions have changed. Please refer to the tables below for all BAT, BLT and BST valves 3/4" through 2". For 1/2" sizes and diverter valves (F & BFS), the dimensions in Catalog ASO-3 still apply.

SERIES "BST-NC"
&
SERIES "BST-NO"

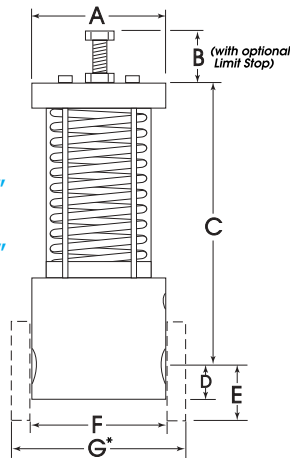

SERIES "BST-NC" DIMENSIONS

	in. 3/4"	mm	in. 1"	mm	in. 1 1/4"	mm	in. 1 1/2"	mm	in. 2"	mm
A	3 1/2	88.9	3 3/4	95.3	4 9/16	115.9	5	127.0	6	152.4
B _(max)	1 3/4	44.5	1 3/4	44.5	1 5/8	41.3	1 3/4	44.5	2 3/8	60.3
C	9 3/8	238.0	11 5/16	287.3	13	330.2	15	381.0	15 13/16	401.6
D	1 5/32	29.2	1 3/8	34.8	1 25/32	45.2	1 25/32	45.2	1 15/32	37.1
E	1 15/16	49.2	2 1/8	53.8	2 5/16	58.7	2 1/2	63.5	3	76.2
F	3	76.2	4	101.6	4 1/2	114.3	6	152.4	5	127.0
G*	4	101.6	5	127.0	5 3/4	146.1	7 3/8	187.2	8 1/2	215.9

SERIES "BST-NO" DIMENSIONS

	in. 3/4"	mm	in. 1"	mm	in. 1 1/4"	mm	in. 1 1/2"	mm	in. 2"	mm
A	3 1/2	88.9	3 3/4	95.3	4 9/16	115.9	5	127.0	6	152.4
B _(max)	1 3/4	44.5	1 3/4	44.5	1 5/8	41.3	1 3/4	44.5	2 3/8	60.3
C	9 1/16	230.1	9 15/16	236.5	11 5/16	287.3	14 1/8	358.6	14 3/4	374.7
D	1 5/32	29.2	1 3/8	34.8	1 25/32	45.2	1 25/32	45.2	1 15/32	37.1
E	1 15/16	49.2	2 1/8	53.8	2 5/16	58.7	2 1/2	63.5	3	76.2
F	3	76.2	4	101.6	4 1/2	114.3	6	152.4	5	127.0
G*	4	101.6	5	127.0	5 3/4	146.1	7 3/8	187.2	8 1/2	215.9

G* Dimension is inlet-to-outlet with optional flanged ends.

SERIES "BAT"
&
SERIES "BLT"

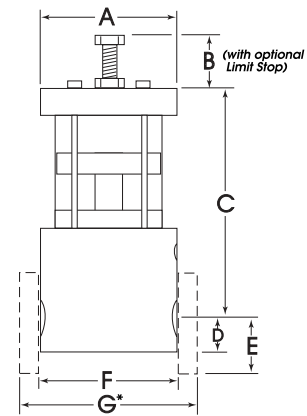

SERIES "BAT" DIMENSIONS

	in. 3/4"	mm	in. 1"	mm	in. 1 1/4"	mm	in. 1 1/2"	mm	in. 2"	mm
A	3 1/2	88.9	3 3/4	95.3	4 9/16	115.9	5	127.0	6	152.4
B _(max)	1 3/4	44.5	1 3/4	44.5	1 5/8	41.3	1 3/4	44.5	2 3/8	60.3
C	6 9/16	166.6	7 3/8	187.2	8 5/16	211.1	9	228.6	10 3/16	258.6
D	1 5/32	29.2	1 3/8	34.8	1 5/8	41.1	1 7/8	47.5	1 15/32	29.2
E	1 15/16	49.2	2 1/8	53.8	2 5/16	58.7	2 1/2	63.5	3	76.2
F	3	76.2	4	101.6	4 1/2	114.3	6	152.4	5	127.0
G*	4	101.6	5	127.0	5 3/4	146.1	7 3/8	187.2	8 1/2	215.9

SERIES "BLT" DIMENSIONS

	in. 3/4"	mm	in. 1"	mm	in. 1 1/4"	mm	in. 1 1/2"	mm	in. 2"	mm
A	3 1/2	88.9	3 3/4	95.3	4 9/16	115.9	5	127.0	6	152.4
B _(max)	1 3/4	44.5	1 3/4	44.5	1 5/8	41.3	1 3/4	44.5	2 3/8	60.3
C	5 5/16	134.9	5 9/16	141.2	6 3/8	161.8	6 5/8	168.2	8 7/8	225.3
D	1 5/32	29.2	1 3/8	34.8	1 7/8	47.5	1 7/8	47.5	1 1/2	38.1
E	1 15/16	49.2	2 1/8	53.8	2 5/16	58.7	2 1/2	63.5	3	76.2
F	3	76.2	4	101.6	4 1/2	114.3	6	152.4	5	127.0
G*	4	101.6	5	127.0	5 3/4	146.1	7 3/8	187.2	8 1/2	215.9

G* Dimension is inlet-to-outlet with optional flanged ends.



PLAST-O-MATIC VALVES, INC.

1384 Pompton Avenue, Cedar Grove, New Jersey 07009-1095
(973) 256-3000 • Fax (973) 256-4745 • www.plastomatic.com